

22260085	DATA SHEET	
Valid from: 12.09.2019	AB-C4-M12FS-M16-PO-0,5	

Description

S/A flush-type socket, 4-pos., M12, A-coded, quick locking, front/screw mounting with M16 thread, can be positioned, 0.5 m TPE litz wire, 4 x 0.34 mm²

General data

Rated current at 40°C	4 A
Rated voltage	250 V
Number of positions	4
Contact resistance	≤ 3 mΩ
Insulation resistance	≥ 100 MΩ
Length of cable	0.5 m
Ambient temperature (operation)	-25 °C ... 85 °C (Male connector / female connector)



General characteristics

Standards/regulations	M12 connector IEC 61076-2-101
Coding	A - standard
Surge voltage category	II
Pollution degree	3
Degree of protection	IP67
Contact material	CuZn
Contact surface material	Ni/Au
Contact carrier material	PA 66
Material, knurls	Zinc die-cast, nickel-plated
Sealing material	NBR
Mounting type	Front mounting M16 x 1.5 with locking nut
Connection method	Individual wires
Status display	No

Conduct data

Cable type	TPE litz wire
Conductor cross section	0.34 mm ²
AWG signal line	22
Conductor structure signal line	7x 0.25 mm
Core diameter including insulation	1.2 mm ±0.07 mm
Thickness, insulation	0.21 mm
Wire colors	black, brown, blue, white, gray
Insulation resistance	≥ 20 MΩ*km
Conductor resistance	≤ 57.6 mΩ/m
Nominal voltage, conductor	300 V
Test voltage, conductor	2000 V AC
Material conductor insulation	TPE
Conductor material	Tin-plated Cu litz wires
Ambient temperature (operation)	-25 °C ... 90 °C (cable, fixed installation)

Creator: PAMA7/PDP Released: IVSE1/PDP	Document: DB22260085EN Version: 03	Page 1 of 2
---	---------------------------------------	-------------

22260085	DATA SHEET	
Valid from: 12.09.2019	AB-C4-M12FS-M16-PO-0,5	

Technical drawings and dimensions

Dimensional drawing

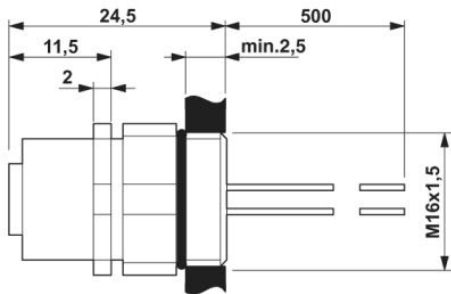

Dimensional drawing

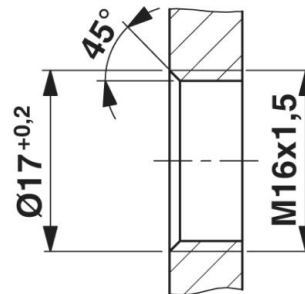

Drawing

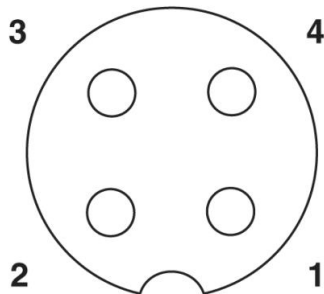

Circuit diagram

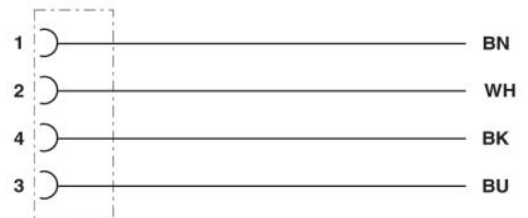

Application range

Connection of enclosures and cabinets

Note

Photographs are not true to scale and do not represent detailed images of the respective products.

Creator: PAMA7/PDP Released: IVSE1/PDP	Document: DB22260085EN Version: 03	Page 2 of 2
---	---------------------------------------	-------------